

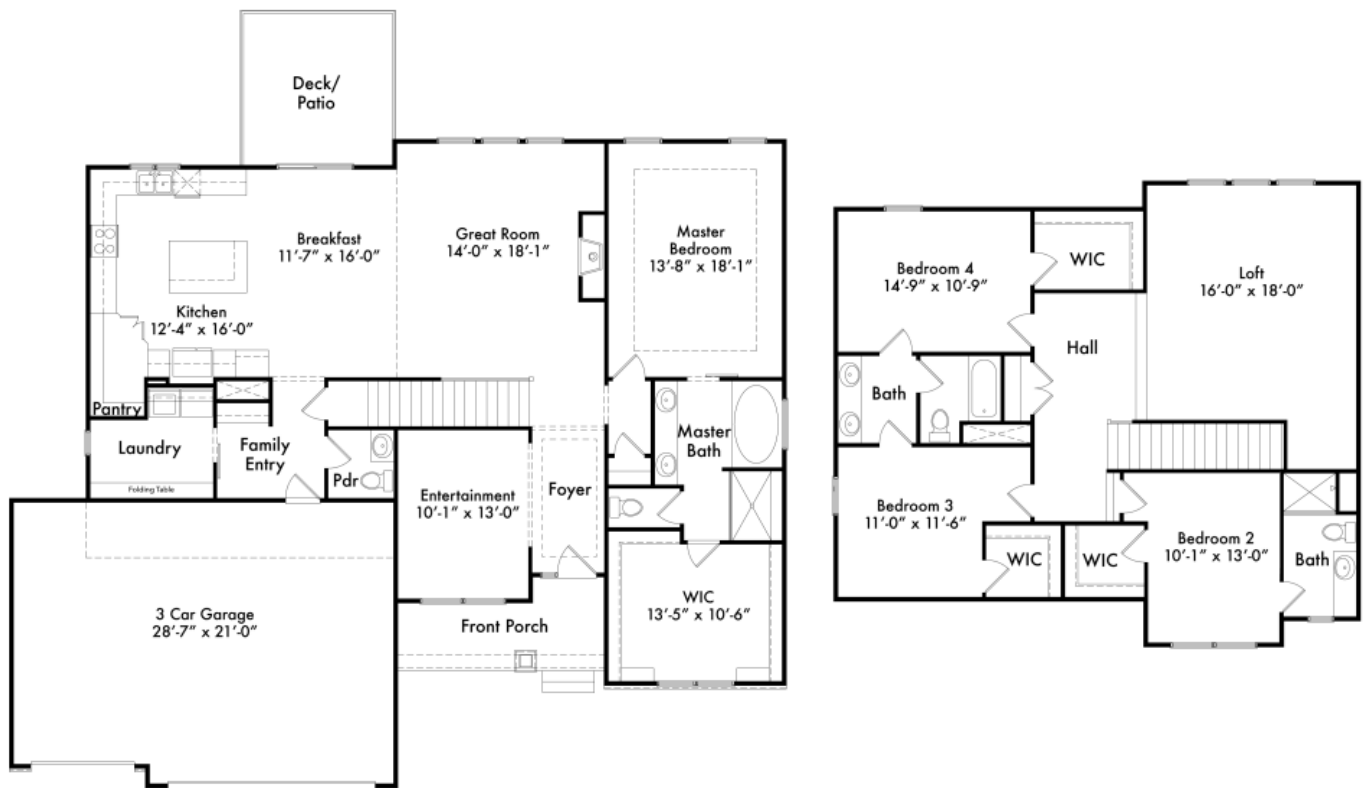

## The HILLSDALE MODERN

1.5 STORY  
4 BEDS  
3.5 BATHS  
3020 SQFT



[www.hearthsidekc.com](http://www.hearthsidekc.com)  
[info@hearthside-kc.com](mailto:info@hearthside-kc.com)

Follow The Fun:



### DESIGN CENTER

1915 Industrial Dr  
Suite 300, Liberty,  
MO 64068

**(816) 781-0234**

*Homes may vary slightly from drawings shown.  
Room dimensions and sqftg is approximate.*

# **HILLSDALE**

## **PLAN FEATURES**

- Hardwood In Foyer, Kitchen, Breakfast, Garage Entry, Entertainment, Great Room & 1/2 Bath
- Fireplace With Wrap Panel To Ceiling
- Granite Kitchen Countertops
- Kitchen Island With 2 Pendant Lights
- Range Hood
- Raised Loft Space
- 3-Car Garage With 8' Doors
- 2nd Wall Paint Color
- Wainscoting In Entertainment Room
- Delta Woodhurst Bath Faucets
- I-Joist Floor System
- Custom Window Trim In Family Room
- Stairs With Designer Carpet & Wood End Caps
- Crown Molding In Foyer & Entertainment Room
- Crown Molding In Master Bedroom
- UnderMount Master Bathtub
- Frameless Master Shower Glass
- Granite Master Shower Seat
- Tile Wall & Floor In Master Shower
- Tile Floor In All Bathrooms & Laundry Room
- Granite Countertops In All Bathrooms
- Yard Irrigation
- \$3,100 Lighting Allowance
- \$1,750 Landscape Allowance

## **HEARTHSIDE HOMES**

We understand building a home can be a daunting process. You want to make sure the price point is right, the quality meets your expectations, and the entire process doesn't take forever! With Hearthside Homes, you'll have a team of passionate designers and construction professionals to lead the way. We place an emphasis on including you in on the entire project, by keeping you up-to-date on the complete schedule!

### **A Team Of Experts:**

- Specialty Field Supervisors
- In-House Design Professional
- Dedicated Warranty Manager
- 30+ Years of Experience

### **24/7 Online Access to YOUR:**

- Construction Schedule
- Change Orders
- Contract Documents
- Job Photo Library